

# TruLine<sup>80</sup>

EVOLUTIONARY AUDIO



USER MANUAL

# THANK YOU.

Thank you for purchasing this TRUUNE Eighty (80) home audio system, handmade with top studio-quality components and certified ecological materials. TRUUNE Eighty (80) is designed to deliver the most faithful sound and timeless design for generations of listeners.

Register your product at [www.truune.com](http://www.truune.com) and gain access to your Evolutionary account with the latest software and hardware updates for your product.

Please read this manual before connecting your new speakers for the first time.

truune

# CONTENTS

CONTENTS .....	3
UNPACKING .....	4
TRANSPORTING YOUR SPEAKERS .....	4
INSTALLATION AND CONNECTION .....	4
PACKAGE CONTENTS .....	5
SPEAKER DESCRIPTION .....	6
MASTER /ACTIVE/ SPEAKER .....	7
SLAVE /PASSIVE/ SPEAKER .....	7
RECOMMENDED SPEAKER PLACEMENT .....	8
SPEAKER INSTALLATION .....	9
INPUT SELECTION .....	14
CONTROLLING THE SPEAKERS USING THE TOUCHSCREEN PANEL .....	15
CONTROLLING THE SPEAKERS USING THE LEGACY PLAYER APP .....	16
INPUT CONNECTIONS AND MUSIC PLAYBACK .....	18
MULTIROOM .....	21
SPEAKER MENU .....	22
EQUALIZER .....	23
SYSTEM SETTINGS .....	25
NETWORK SETTINGS .....	31
TRUUNE EIGHT (80) ACCESSORIES .....	32
CHANGING ACOUSTIC RINGS .....	32
CLEANING AND MAINTENANCE .....	34
FREQUENTLY ASKED QUESTIONS .....	35
TECHNICAL SPECIFICATIONS .....	36
INFORMATION ON DISPOSAL AND RECYCLING .....	37
DECLARATION OF CONFORMITY .....	37
LEGAL NOTICES AND COPYRIGHT .....	38
IMPORTANT SAFETY INSTRUCTIONS .....	39

## UNPACKING

Remove all packaging materials from the device. Store the packaging material for future use. If you dispose of the packaging, please comply with all local regulations.

## TRANSPORTING YOUR SPEAKERS

Store the original box and packaging materials. If you need to send or move a speaker, repack it in the original packaging as it provides maximum protection.

## INSTALLATION AND CONNECTION

This device is compatible with 115 to 230 V power. Connecting this device to any other power source may result in damage.

- Connect the product per the instructions provided in this manual
- Only connect the product to the proper voltage as specified on the product
- Be sure to not step on the power cord as it may become disconnected or pinched, especially at the power socket or the outlet from the speaker.

## PACKAGE CONTENTS

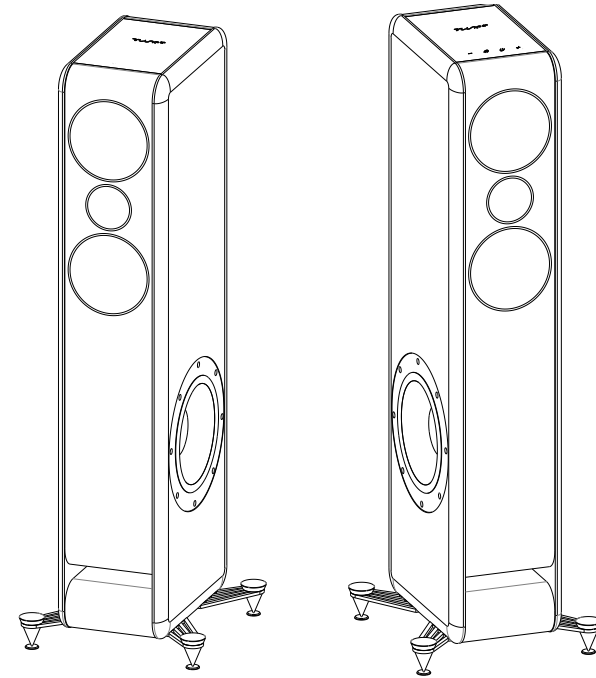

1 x basic  
remote control



2 x power supply



1 x connecting cable

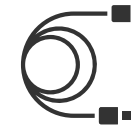

1 x optical cable



\*contents may vary depending on your region

## SPEAKER DESCRIPTION

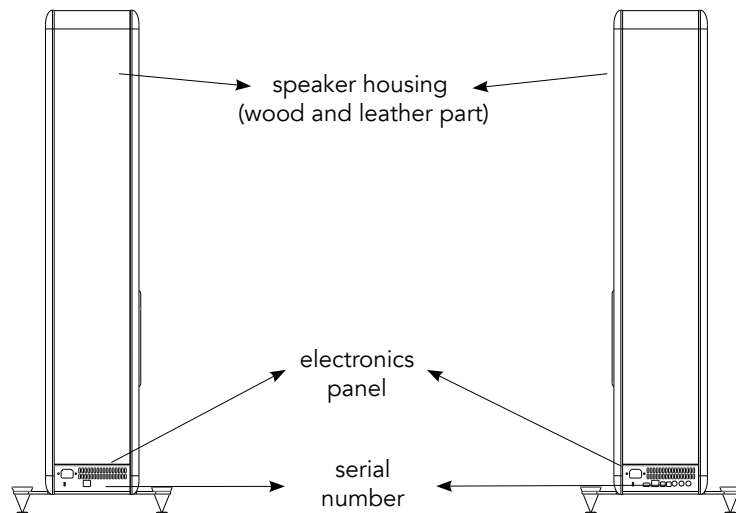
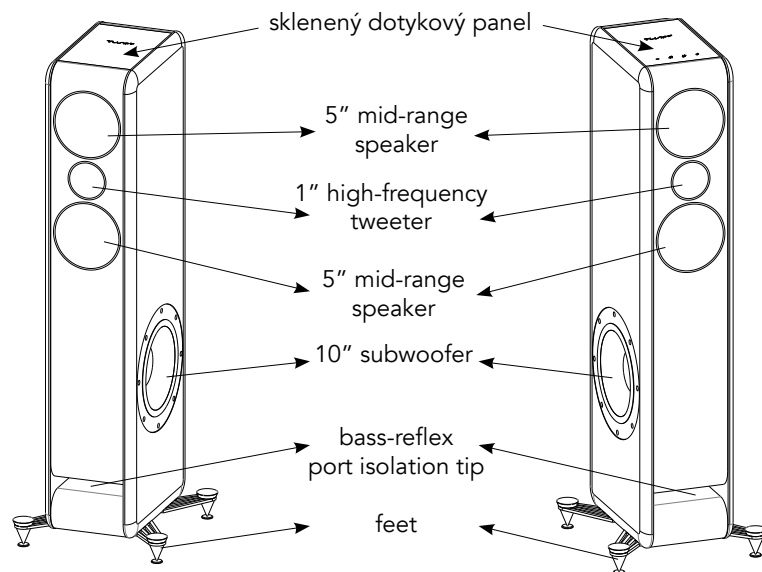

Ensure no items are inserted into the bass-reflex port.  
The port cannot be removed by the user to remove such inserted item.

## MASTER /ACTIVE/ SPEAKER

(touchscreen display)

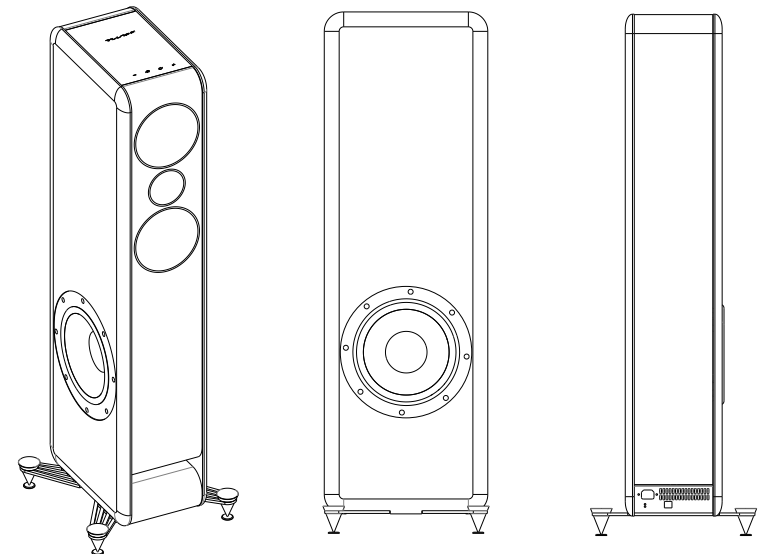

## SLAVE /PASSIVE/ SPEAKER

(without touchscreen display)

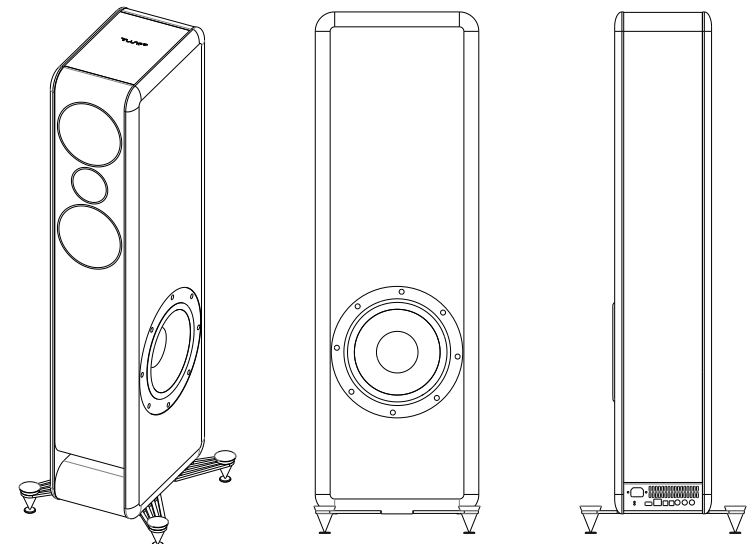

## RECOMMENDED SPEAKER PLACEMENT

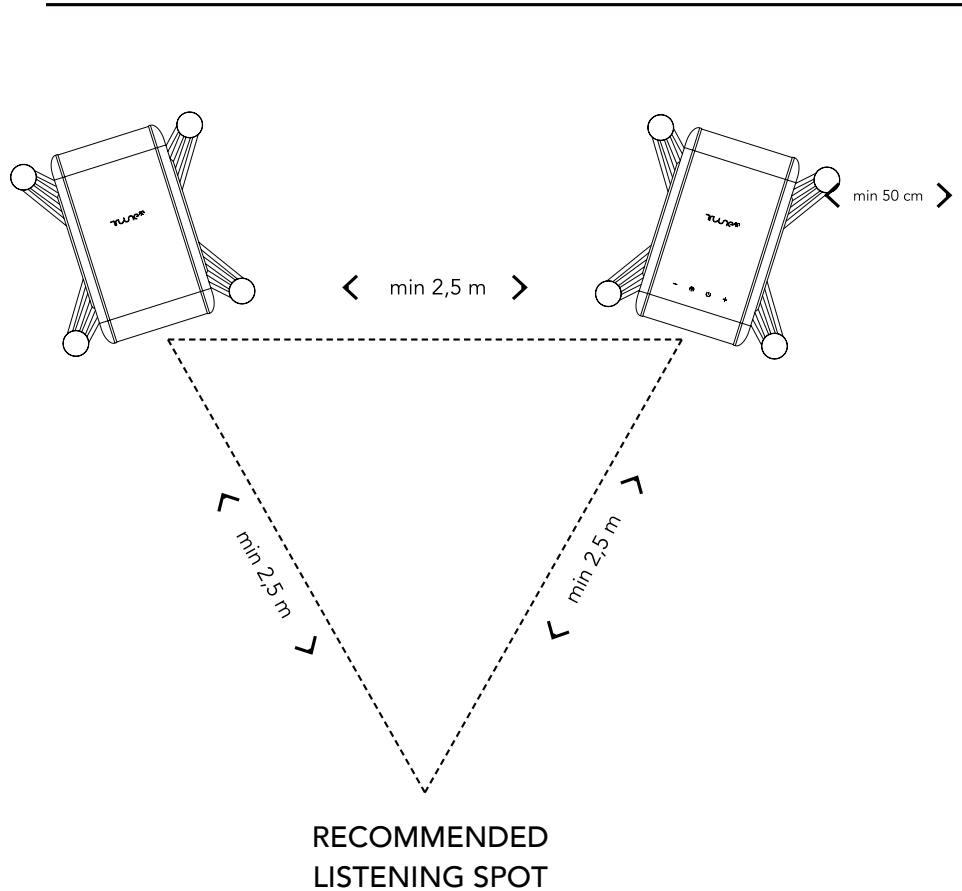

It is recommended to position the subwoofers facing each other, but it depends on the room's acoustics.

## SPEAKER INSTALLATION

The speaker must be paired with your home Wi-Fi network to make full use of the speakers. Please follow the instructions provided in this manual.

### 1 CONNECTING THE SPEAKERS TO POWER

Use the provided connection cable to connect the active speaker to the passive speaker.  
Use the provided power cable to connect the active and passive speakers to the power source.

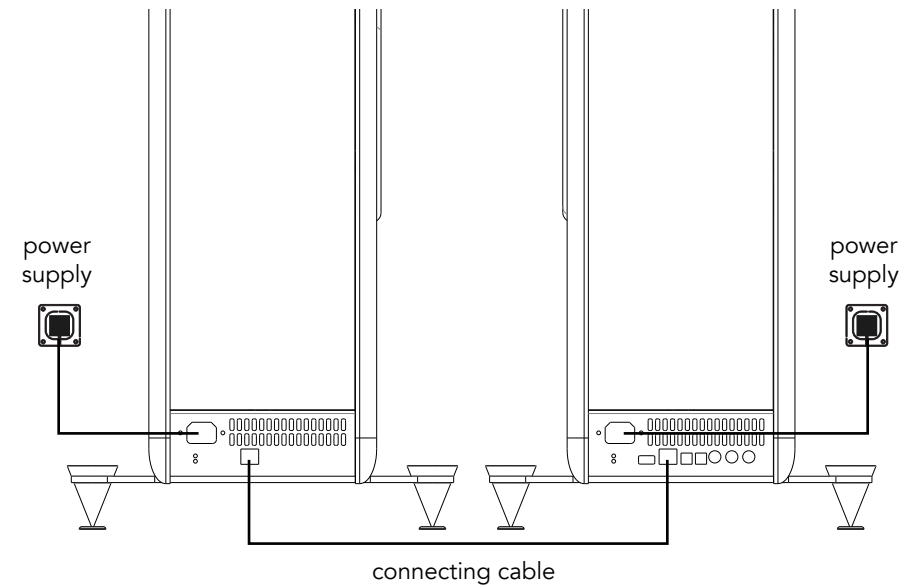

### 2 TURNING THE SPEAKERS ON FOR THE FIRST TIME

Turn on the speaker and wait approximately 30 seconds. The tone indicates that the speaker is ready for use.

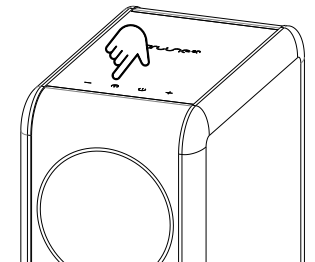

### 3 INSTALLING THE APP

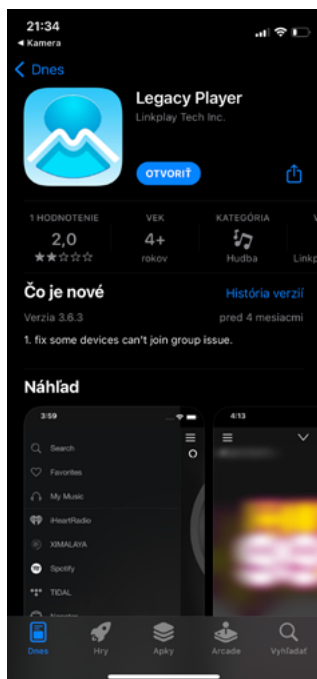

Download and then install the free Legacy Player app on your mobile device.

NOTE: Update the app regularly.

Download from the  
**Apple Store**



Download from  
**Google Play**



### APP SETTINGS

Connect to the TRUUNE Eight (80) speaker in your Wi-Fi settings on your mobile device.

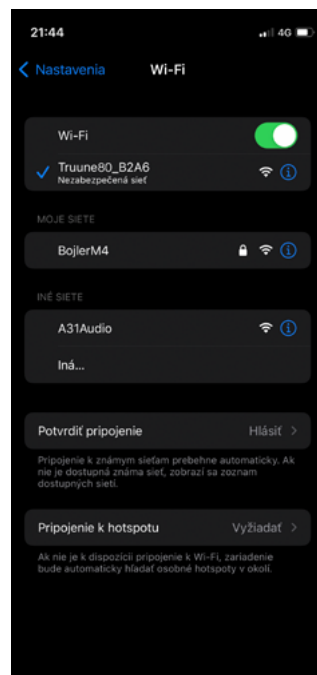

### 5 LAUNCHING THE APP

Launch the Legacy Player app and select "Add device". Connect the speaker to your private network, enter the network password and press "Continue". Press "Next" once you are connected to your home network.

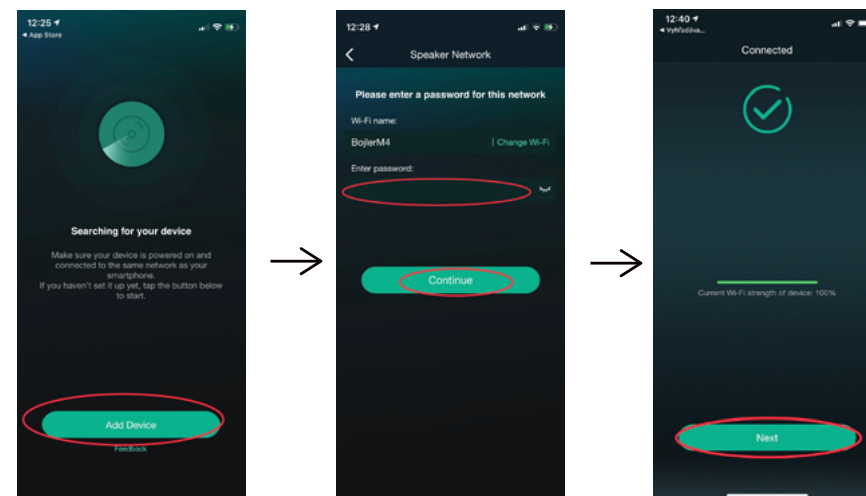

### 6 CONNECTING TO YOUR HOME NETWORK

The app will ask you to return to the Settings on your mobile device and to connect to your home Wi-Fi network.

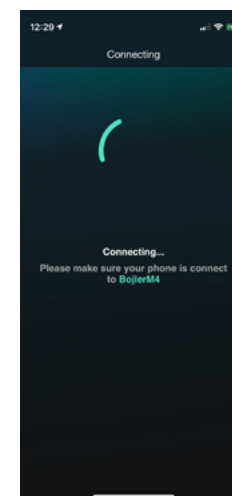

### 7 TURN OFF LEGACY PLAYER

After connecting to your home network, go back to Legacy Player. The Legacy Player app may need to be closed and relaunched before starting again.

## 8 LAUNCH LEGACY PLAYER

Relaunch Legacy Player. If the product appears in the "Device list", your speaker is ready for use.\*

### Playing from other network-connected devices:

once your speaker is connected to your home network, any device on your home network (tablet, PC, etc.) may be used to control the speaker (Wi-Fi, AirPlay). It must be connected to the same Wi-Fi network.

\* If you are unable to successfully connect the speaker to your network, reset the device using the "NETWORK RESET" instructions (page 30) and start over from step 1 above.

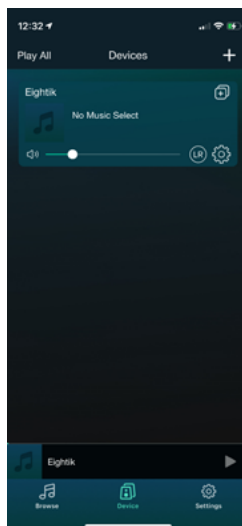

## 9 NAME YOUR SPEAKERS

Choose a name for your speakers. Press "FINISH" after you have entered the name.

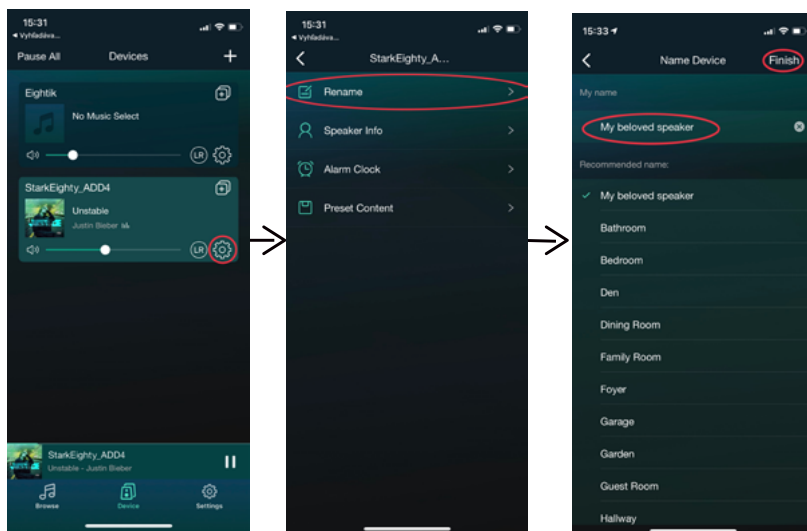

### PLAYING MUSIC OVER THE NETWORK

After you have successfully connected the speakers to your home network per Point 2.1. "Speaker Installation", the speakers may be used over your home network (Wi-Fi, AirPlay) from any device (tablet, PC, etc.) connected to your home network.

# INPUT SELECTION

Select a speaker input using the "INPUT" button on the top panel on the active speaker. Scroll to the selected input on the display to select that input (nothing needs to be confirmed).

The speaker will learn which inputs you use the most and will offer those first.

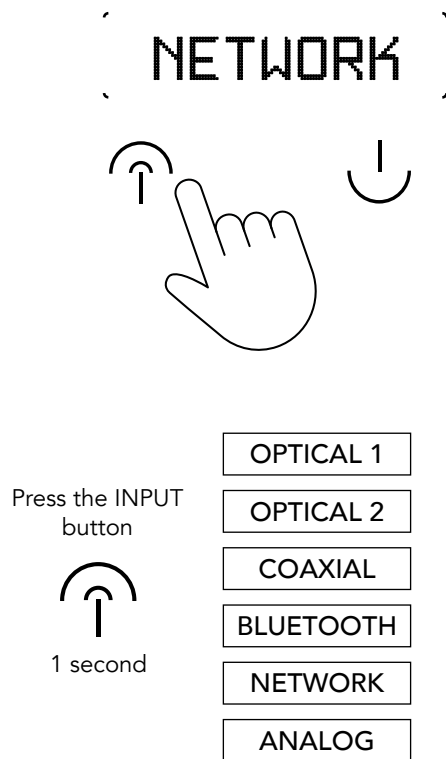

# CONTROLLING THE SPEAKERS USING THE TOUCHSCREEN PANEL

The speakers are controlled using the controls on the top panel of the active speaker. It is necessary to consistently touch the control button for 1 second.



	—	⬆	⬇	+
SHORT TOUCH (1 second)	decrease volume	change input	power on the speakers	increase volume
LONG TOUCH (3 seconds)		enter the speaker menu	power off the speakers	



## CONTROLLING THE SPEAKERS USING THE LEGACY PLAYER APP

### PLAYING STREAMING MUSIC USING LEGACY PLAYER

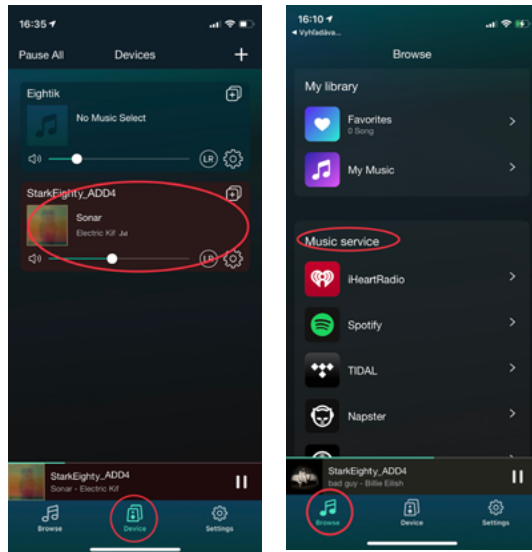

1. Launch the Legacy Player app
2. Select your device from the "Device List"
3. After selecting the device from which you want to play music, click "Browse"
3. Enter your login name and password for the streaming service you use (e.g. Tidal, Spotify, etc.) into Legacy Player
4. Turn on playback for your selected music

### PLAYING MUSIC FROM A DLNA SERVER

1. Launch the Legacy Player app
2. Select your device in the "Device List"
3. Select "Browse" in the app menu
4. Click "My music"
5. Select the server
6. Turn on playback for your selected music

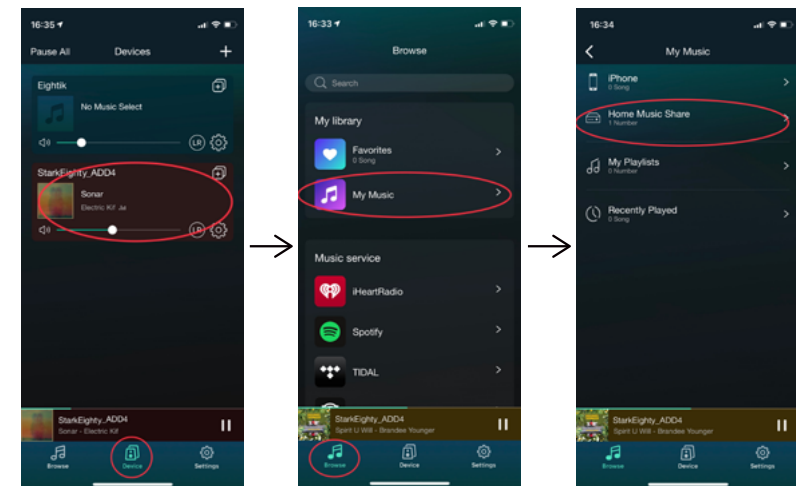

### SELECTING INPUTS USING THE LEGACY PLAYER APP

Select the device you want to control in the Legacy Player app and then click "Browse" to show the inputs and music playback options.

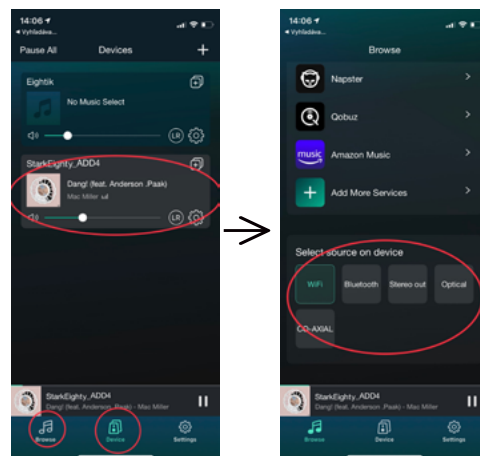

### CONTROLLING VOLUME USING THE LEGACY PLAYER APP

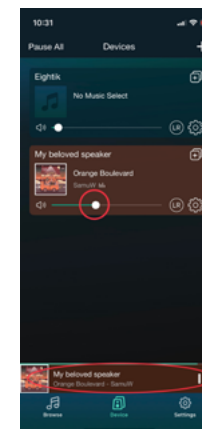

Select the device to control in the Legacy Player app and use the slider to control the volume for every input. Moving the slider increases the volume slowly and gradually. You can increase the volume using the quick buttons found on every phone. The volume increase is not as proportional (3x faster) as on the touchscreen panel or the remote control.

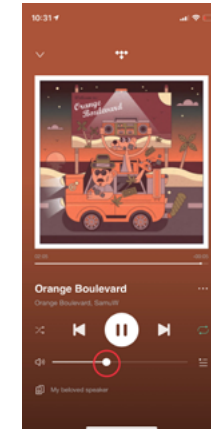

After clicking on the song being played (see the image at the bottom left), we will see the album or song being played in more detail, where you can also control the volume by moving the slider.



## INPUT CONNECTIONS AND MUSIC PLAYBACK

### USB

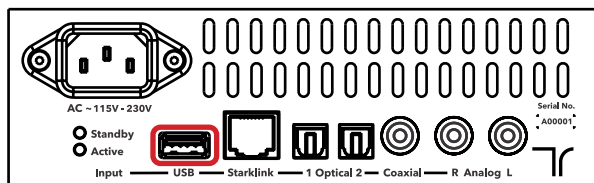

1. The rear panel on the active speaker has a USB-A input
2. Music playback is enabled immediately when a USB device is connected to the speaker
3. Music from the USB device may be controlled from the speaker control panel or using the Legacy Player app.

\*supported formats: MP3/WMA/AAC/AAC+/  
/ALAC/FLAC/APE/WAV

### STARKLINK

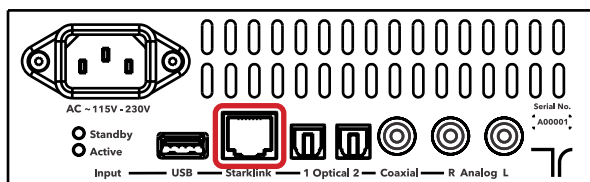

A Starklink output is located on the rear panel on both the active and passive speakers to connect additional TRUUNE Eighty (80) accessories.

#### ATTENTION:

This is not a LAN (RJ45) connector and making such connection may cause the speaker to temporarily malfunction (due to protection), in case of malfunction, please reset the speakers; after resetting them, they will return to factory settings and work.

### COAXIAL

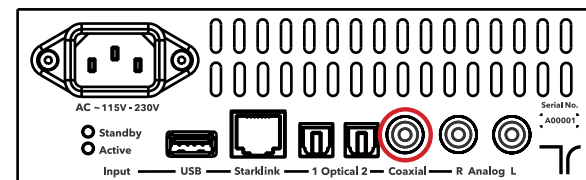

- The coaxial input is used to connect any device that supports a coaxial connection (e.g. a record player)
- When connecting any other cable, make sure the power cord (for the device) is unplugged

### OPTICAL 1

### OPTICAL 2

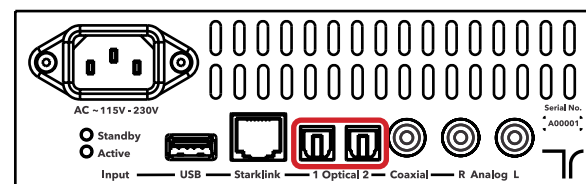

- An optical connection is the best quality for wireless audio transmission, so we recommend this connection for its highest possible music transmission quality
- An optical cable can be used to connect, for example, televisions, CD and DVD players, game consoles, computers and other devices
- There are 2 optical inputs on the back panel of the active speaker
- An optical cable is included in the package
- Connect your device using an optical cable
- Select the optical input on the speaker by repeatedly pressing the "INPUT" button on the top display of the active speaker until you see: OPTICAL 1 or OPTICAL 2

### ANALOG

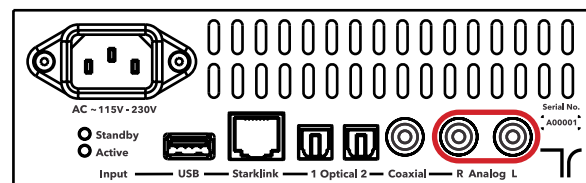

- A record player can also be connected via the analogue input, but a record player pre-amplifier must be connected (in some record players, the pre-amplifier is already built in)
- It is mainly used to connect older types of various electronic devices that do not yet have an optical or coaxial output

## BLUETOOTH

- Use the "INPUT" button on the speaker control display to select the "BLUETOOTH" input
- Turn on Bluetooth on your device (smartphone, tablet, etc.)
- Select the "TRUE Eighty (80)" speakers on your device (or use the name you gave your speakers during installation) and confirm to pair the device
- The speakers are now ready to use via Bluetooth
- With the help of Bluetooth technology, it is possible to easily connect devices equipped with this technology to each other via a short wireless connection
- If the device is moved away from the speakers, it will be disconnected
- Communication between devices connected via Bluetooth may not be stable

## NETWORK

- Instructions for connecting speakers in the "NETWORK" mode can be found in the "Speaker Installation" chapter
- If you have made the correct initial connection, your speakers are ready for network use
- If you want to start music through the Legacy player, you need to have the NETWORK input selected on the speaker
- If you use the network the most, you can pre-set it as the selected input on the speaker
- The pre-set of the selected input can be found in the "System Settings" chapter

## MULTIROOM

One music source, multiple rooms and the same music everywhere. This solution allows you to connect multiple speakers to a single system to provide sound to your entire flat, house, or commercial space.

Multiroom is a speaker system that you can use to provide sound to multiple rooms at the same time with one music source. You can also build your sound system gradually. When choosing, however, you have to think about the fact that speakers may not "understand" each other across brands. The Legacy Player app allows you to pair found devices in a convenient way, by adding the devices you want to play in multiroom mode in the "Device List" using the "plus" button.

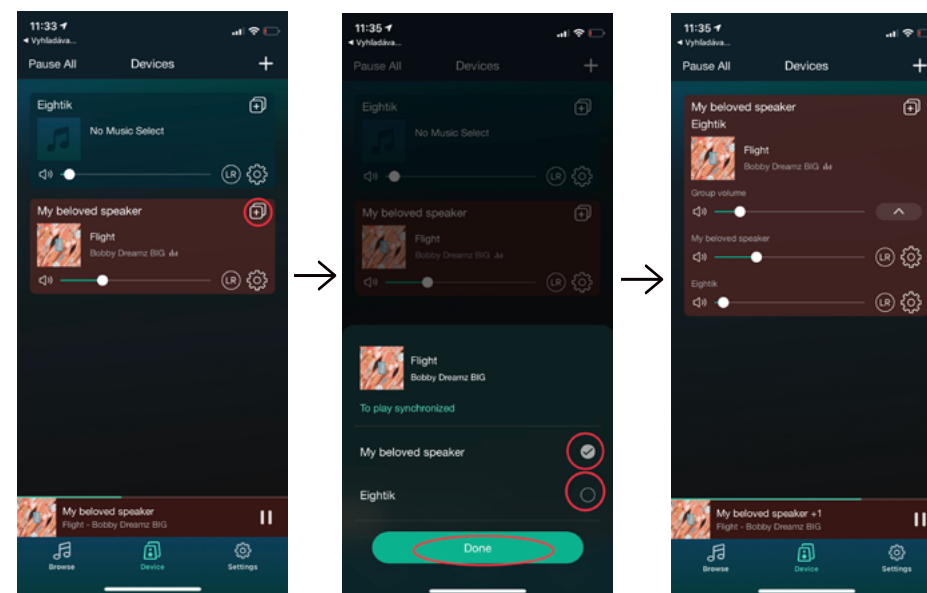

## BASIC REMOTE CONTROL

The receiver on the display is very sensitive: simply point the remote control at the ceiling and the sensor will detect the reflection and work reliably. There is no need to raise your arm, or otherwise point the basic remote control at the top of the display. The speakers are turned on and off using the remote control. Other buttons make it easy to switch inputs, control the volume and turn the sound on and off.

## MENU REPRODUKTORA

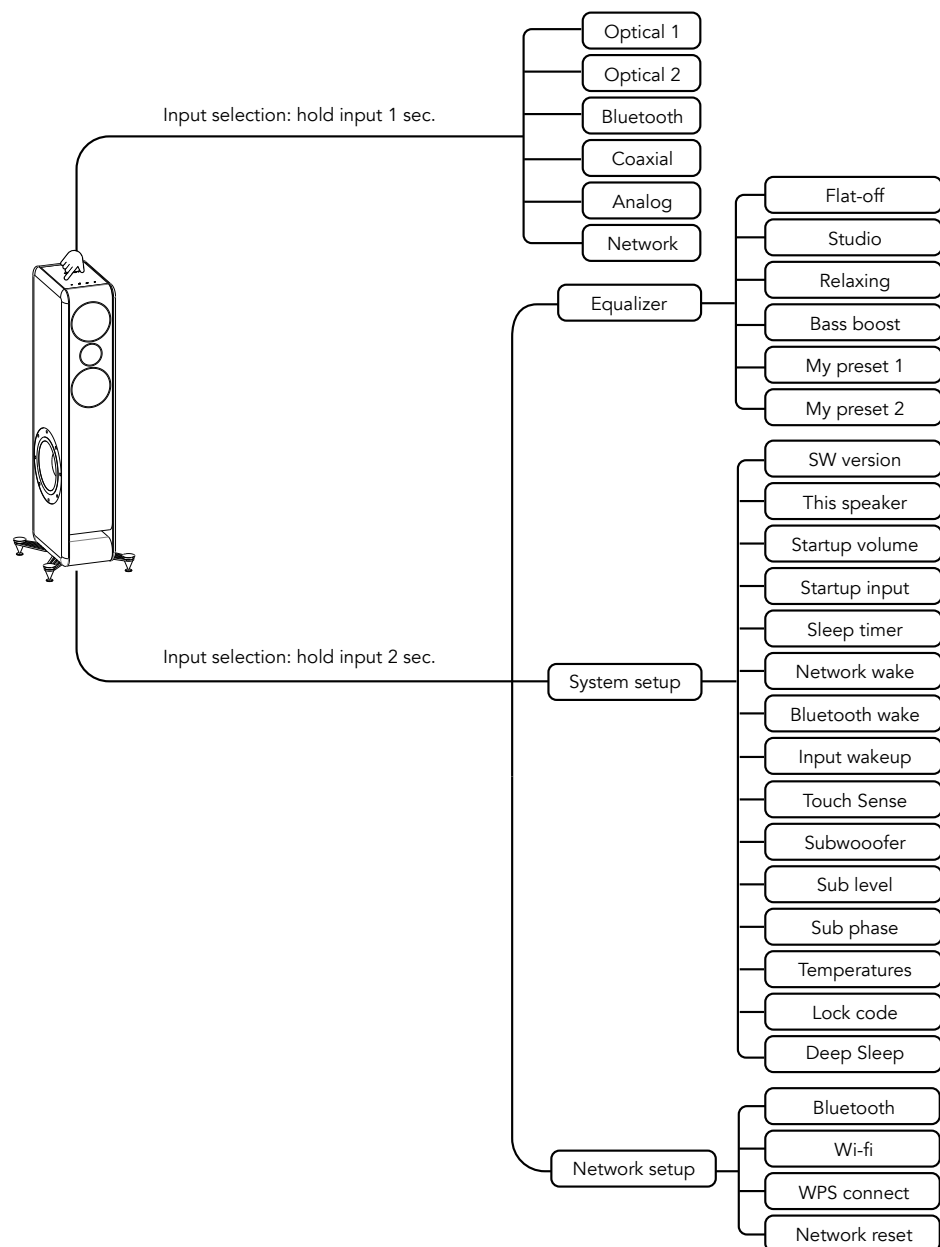

## EQUALIZER

- Sound is essentially a wave, and the pitch of a given tone is determined by its frequency
- Serious equalizer adjustments require time, careful listening and at least an average ear for music
- Improper adjustment of the equalizer can easily degrade the resulting speaker sound
- Our speakers offer pre-set and recommended equalizer
- Factory default settings for a new speaker have the equalizer off with FLAT OFF settings
- The equalizer itself does not need to be adjusted as long as the speaker is well placed in a suitable room
- You only adjust the equalizer if you want to adjust the sound (for example, you need more bass, less treble, etc.)
- The equalizer is adjusted as follows: hold down the "INPUT" button to access the menu, EQUALIZER will appear. Press "INPUT" to confirm, use the + and - buttons to select the equalizer according to the menu, and the selected equalizer is saved automatically

EQUALIZER	FLAT - OFF	<ul style="list-style-type: none"> <li>• The equalizer is disabled with this setting</li> <li>• Linear progression of the entire speaker response frequency</li> </ul>
	STUDIO	<ul style="list-style-type: none"> <li>• With this option, details in the middle band are highlighted</li> </ul>
	RELAXING	<ul style="list-style-type: none"> <li>• A smoother sound for long-term listening and reading</li> <li>• The highs and mids are slightly reduced in this equalizer setting</li> </ul>
	BASS BOOST	<ul style="list-style-type: none"> <li>• Bass is emphasised in this setting for bass lovers</li> </ul>
	MY PRESET 1	<ul style="list-style-type: none"> <li>• User adjustable 10-band equalizer</li> </ul>
	MY PRESET 2	<ul style="list-style-type: none"> <li>• Hold down the "INPUT" button to access the menu, press the "INPUT" button again to access the equalizer setting, use the + and - buttons to scroll to "MY PRESET 1" and touch the "INPUT" button to confirm. By pressing the + and - buttons, you set the value change in the bands. You click between individual bands by touching the "INPUT" button</li> <li>• The selected settings are saved automatically</li> <li>• Press "POWER ON" to stop entering values</li> </ul>

## SYSTEM SETTINGS

SYSTEM SETUP	SW VERSION	<ul style="list-style-type: none"> <li>• Current software version</li> </ul>
	THIS SPEAKER	<ul style="list-style-type: none"> <li>• This function serves to correctly position the side of the active speaker in a stereo setup</li> <li>• The speakers are automatically set to use the active speaker on the right side</li> <li>• In case you have the active speaker on the left hand side, you need to make the following change in these settings: On the display, hold down the "INPUT" button to access the menu, use the + and - buttons to go to "SYSTEM SETUP", press INPUT to confirm, use the + button to navigate to "THIS SPEAKER" and press the "INPUT" button to complete the change</li> <li>• The selected setting will be saved automatically after about 30 seconds, or press the "POWER ON" button to exit the settings and the selected setting will be saved automatically</li> </ul>
	START UP VOLUME	<ul style="list-style-type: none"> <li>• This function sets the volume when the speaker is turned on</li> <li>• You have 2 options in these settings               <ol style="list-style-type: none"> <li>1. remembering the last volume before the speaker was turned off</li> <li>2. adjustable start up volume</li> </ol> </li> </ul>

## SYSTEM SETUP

## START UP VOLUME

- Hold down the "INPUT" button to access the menu, use the + and - buttons to scroll through the menu, select the "SYSTEM SETUP" setting, confirm with the "INPUT" button, use the + and - buttons to scroll through the settings, select STARTUP VOLUME and use the "INPUT" button to make changes
- Use the + and - buttons to set the start up volume
- The selected setting will be saved automatically after about 30 seconds or press the "POWER ON" button to exit the settings and the selected setting will be saved automatically

## START UP INPUT

- This setting is used to remember the input, or to set the default start up input
- This option enables the speaker to remember the last input selected
- Hold down the "INPUT" button to access the menu, use the + and - buttons to scroll through the menu, click on "SYSTEM SETUP", confirm with the "INPUT" button, again use the + and - buttons to scroll through the menu, click on STARTUP INPUT, use the "INPUT" button to select from the default options: remember last (remembers the last selected input), optical 1, optical 2, coaxial, Bluetooth, network, analogue

## SYSTEM SETUP

## SLEEP TIMER

- Setting the automatic sleep timer after losing a digital input signal or network playback stoppage
- Hold down the "INPUT" button to access the menu, use the + and - buttons to move through the menu, click on "SYSTEM SETUP", confirm with the "INPUT" button, again use the + and - buttons to scroll through the menu, click on SLEEP TIMER, enter the sleep timer settings using the "INPUT" button, set the time using the + and - buttons and then select the time using the "INPUT" button and save the selected values with the "INPUT" button

## NETWORK WAKE

- Automatically awaken or put the speaker to sleep when using network playback (including Legacy Player)
- Hold down the "INPUT" button to access the menu, use the + and - buttons to scroll through the menu, click on "SYSTEM SETUP", confirm with the "INPUT" button, and again use the + and - buttons to scroll through the menu, click on NETWORK WAKE, and use the "INPUT" button to select the on/off option. The selected setting will be saved automatically after about 30 seconds, or press the "POWER ON" button to exit the settings and the selected setting will be saved automatically

SYSTEM SETUP	BLUETOOTH WAKE	<ul style="list-style-type: none"> <li>Automatic speaker wakeup or sleep when using Bluetooth</li> <li>Hold down the "INPUT" button to access the menu, use the + and - buttons to scroll through the menu, click on "SYSTEM SETUP", confirm with the "INPUT" button, and again use the + and - buttons to scroll through the menu, click on BLUETOOTH WAKE, and use the "INPUT" button to select the on/off option</li> <li>The selected setting will be saved automatically after about 30 seconds or press the "POWER ON" button to exit the settings and the selected setting will be saved automatically</li> </ul>
	INPUT WAKEUP	<ul style="list-style-type: none"> <li>Automatic wake or sleep - the speaker automatically wakes up when a signal is detected</li> <li>Hold down the "INPUT" button to access the menu, use the + and - buttons to scroll through the menu, click on "SYSTEM SETUP", confirm with the "INPUT" button, and again use the + and - buttons to scroll through the menu, click on INPUT WAKEUP, and use the "INPUT" button to select the on/off option</li> <li>The selected setting will be saved automatically after about 30 seconds, or press the "POWER ON" button to exit the settings and the selected setting will be saved automatically</li> </ul>
	TOUCH SENSE 5	<ul style="list-style-type: none"> <li>Sensitivity of the touch glass on the speaker, adjustable from 0 to 10, default setting is 5 (middle)</li> </ul>

SYSTEM SETUP	SUBWOOFER ON	<ul style="list-style-type: none"> <li>Turning on the subwoofer when it is connected to TRUUNE Eight (8) - after turning on this function, it will redirect the bass component to the subwoofer and TRUUNE Eight (8) will only play frequencies above 150 Hz, the speakers will play the entire frequency range when this function is active, but no subwoofer is connected</li> <li>Setting options are On and Off</li> </ul>
	SUB LEVEL 0,0DB	<ul style="list-style-type: none"> <li>Setting the volume of the subwoofer in proportion to the volume of the speakers</li> <li>Setting options are from -12 dB to 12 dB in 1 dB steps, with the default setting being 0</li> </ul>
	SUB PHASE NORMAL	<ul style="list-style-type: none"> <li>Subwoofer phase inversion switch - in some rooms and speaker and subwoofer placements, it is sometimes necessary to invert the phase of the subwoofer to match the phase of the other speakers</li> <li>Switch options are Normal and Inverted</li> </ul>
	TEMPERATURES N/A N/A 55°C 55°C	<ul style="list-style-type: none"> <li>Temperature indicator of the output stages for the TRUUNE Eighty (80) with connected subwoofer from the accessory - all 4 temperatures are present, they are monitored at the same time, and if there is overheating (90°C), the speaker will turn off - this can happen in case of a fan failure, or if exposed in a hot place, in the sun and at the same time operated at a high volume. After cooling it can be turned on again. If a person tries to turn it on when it is overheated, the display will say SYSTEM OVERHEATED and immediately turn off again</li> </ul>



## LOCK CODE OFF

- Option to lock the speaker using a 4 digit PIN code - e.g. to prevent accidental adjustment, such as by small children
- To enter the code, press the "INPUT" button and then +/- to enter the code that the speaker will ask for on the display after the next power-on and it will only turn on after the code has been entered. After a successful one-time entry, the given code will no longer be asked for at the next power-on, but only when entering the same or a different code in the menu.
- If the speaker is blocked, please contact us using the form at <https://www.truune.com/sk/zaruka-a-opravny/> or via email at [support@truune.com](mailto:support@truune.com)

## DEEP SLEEP OFF

- The standby/deep sleep function switch - if it is turned off (Off), input monitoring remains on when the speaker is turned off (sleeps) and the speaker is turned on when a signal is detected via the inputs that are enabled in the system menu
- If it is turned on, after turning it off (sleeping), the speaker goes to the minimum consumption mode (up to 1W), where all automatic wake-up functions are turned off and it can only be turned on from the touch panel on the speaker or by remote control
- Speaker On and Off options

## NETWORK SETTINGS

### NETWORK SETUP

### BLUETOOTH ON

- The network settings have the option to enable or disable the Bluetooth interface
- Hold down the "INPUT" button to access the menu, use the + and - buttons to scroll through the menu, click on "NETWORK SETUP", confirm with the "INPUT" button, then use the "INPUT" button to change Bluetooth on/off and your selection is saved automatically

### Wi-Fi ON

- The network settings have the option to enable or disable Wi-Fi
- Press "INPUT" to change

### WPS CONNECT

- Speaker pairing function with Wi-Fi router with WPS function
- Hold down the "INPUT" function to activate this function

### NETWORK RESET

- Reset all network settings and device name to factory settings
- Hold down the "INPUT" button to access the menu, use the + and - buttons to scroll through the menu, click on "Network reset", confirm by holding down the "INPUT" button
- All network settings are reset to their factory settings

Network reset with the speaker off:

1. with the speaker off, press the "POWER ON" button until "power on" appears
2. "Network reset, Hold input to Reset" then appears
3. confirm by holding down the "INPUT" button
4. after approximately 2 minutes, your speaker is reset to the factory settings (if Network Input is selected, the speaker will audibly announce this)



## TRUUNE EIGHTY (80) ACCESSORIES

### 1 TRUUNE EIGHTY (80) RINGS

- Package contents: 2 small rings, 2 large rings, 1 magnetic changer  
Use the magnetic changer to change rings and avoid damage
- A small dot on the back of the hoop indicates the same direction of the fabric, putting it on the same place will make the direction of the fabric in the same direction

#### CHANGING ACOUSTIC RINGS



The acoustic rings can be removed. When removing them handle carefully to avoid damaging the skin - ideally by using a larger magnet. In case of any damage (to the material by a pet or careless handling), the acoustic rings can be purchased as an accessory at [www.truune.com](http://www.truune.com) (a magnetic changer is included in the package when you order this accessory).

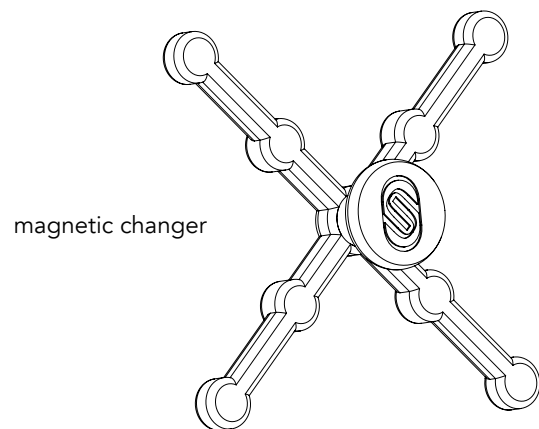

magnetic changer

### 2 SUBWOOFER COVER



The side subwoofer cover is attached magnetically. The cover provides enhanced protection for the subwoofer against physical damage.

## CLEANING AND MAINTENANCE

To avoid electric shock, unplug the speakers before cleaning them. Make sure that water or other liquids cannot touch the speakers and do not submerge the speakers in water or other liquids to prevent an electrical short.

To avoid damaging the speakers, handle them with care: do not use any chemicals or aggressive cleaners (especially those containing isopropyl alcohol, spirits, benzene or thinner), brushes with metal or nylon bristles, or sharp or metal cleaning tools such as knives, blade scrapers and similar devices. They could damage the surface of the speakers.

Use a soft, dry cloth (ideally microfibre) to clean the surface of the speakers.

If the surface is too dirty, use a soft cloth slightly moistened with water. Using excessive pressure when wiping can damage the surface.

Do not leave rubber or plastic products in contact with the speaker for an extended period.

## FREQUENTLY ASKED QUESTIONS

### 1. The speakers do not play any sound

Make sure the speaker is properly plugged in.

The wrong sound source has been selected, or the speaker volume is set too low. Information about the sound source, i.e. about the selection of inputs, can be found in the chapter "Selecting inputs" (p. 14).

### 2. Unable to connect to Wi-Fi device

Wi-Fi is not active on your device (smartphone, tablet, computer, ...), or Wi-Fi is not active on the speaker.

You can find more information about the option to turn Wi-Fi off/on in the "System settings" chapter (p. 25), or reset the speakers using "Network reset" (p. 31).

### 3. Unable to connect or pair with device via Bluetooth

Bluetooth is not active on your device (smartphone, tablet, computer, ...) or Bluetooth is not active on the speaker.

You can find more information about turning Bluetooth off/on in the "System settings" chapter (page 25).

### 4. The Bluetooth connection has been lost

Both Bluetooth devices are too far apart or the connection is affected by an obstacle (wall, furniture, ...).

### 5. The speaker does not respond or the software behaves strangely

A software problem has occurred. Unplug the power cord from the wall outlet, wait 15 seconds, and then plug the speaker back in.

### 6. Crackling is heard in the speakers

It is recommended to listen to the speaker at 50-90 dB; with excessive sound amplification, the "transducer" collides with the magnet.

The amplifier is connected after a power failure (there will be a soft crackling sound - it is a natural characteristic of the speaker).

### 7. The sound is distorted

The volume is set too high.

### 8. The audio stream or audio file is of low quality

We recommend Tidal for streaming music. The bass/treble is set too high on the speaker. You can change them in the equalizer settings, see the "Equalizer" chapter (page 23) for more details.

## TECHNICAL SPECIFICATIONS

### Dimensions:

- Height 1140 mm (44.9 in)
- Width 215 mm (8.5 in)
- Depth 362 mm (14.3 in)

### Weight:

- 82 kg (181 lb) per pair

### Inputs:

- Bluetooth
- Wi-Fi
- 2 x digital optical
- 1 x digital RCA
- 1 x stereo analogue RCA
- 1 x USB max. 1A
- 1 x Wi-Fi Hotspot function
- 1 x Starlink – communication port to control additional accessories

### Network connectivity:

- AirPlay
- Tunes
- DLNA
- Spotify
- Tidal

### Other parameters:

- Frequency range 20 Hz – 20 kHz, -3 dB
- Amplifier 4 x 250W Audiophile Hypex n-Core
- Distortion THD 0.0015 / 1W
- Input power 115-230 V
- Maximum power draw 380 W
- 2x High-End DAC Wolfson WM8742 S - N ratio -123 dB
- Sample Rate Converter – digital interpolation and upscaling 192 kHz
- Sigma Delta 56-Bit digital audio processor with switchable 10-band equalizer
- Maximum relative humidity 85% non-condensing
- Ambient temperature during operation 0 - 50 °C

The manufacturer reserves the right to change data without prior notice. User manual valid as of 01/11/2022 for software version 1.13

## INFORMATION ON DISPOSAL AND RECYCLING



The product must not be disposed of as normal household waste. The WEEE Waste Electrical and Electronic Equipment Directive applies in EU countries and other European countries with separate waste disposal regulations.

When the product reaches the end of its useful life, dispose of it in accordance with local laws and regulations, for example by taking it to a collection yard designated by local or regional authorities. If you are not sure about the procedure, contact these authorities or your waste management provider to provide you with detailed information regarding the collection, reuse and recycling system.

By taking the above steps when disposing of this product, you will help conserve natural resources and ensure that the product is recycled in a way that protects human health and the environment.

## DECLARATION OF CONFORMITY



Truune s.r.o. declares that this product meets the basic requirements and other relevant provisions of Directive 2014/53/EU on Radio equipment (RED) and Directive 2011/65/EU on Restrictions on the use of certain hazardous substances in electrical and electronic equipment (RoHS).

# LEGAL NOTICES AND COPYRIGHT

The construction of the device and packaging is the property of Stark s.r.o. ("Stark").

TRUUNE Eighty (80), the relevant logo, the name "TRUUNE Eighty (80)" and the right to the visual appearance of the product "TRUUNE Eighty (80)" and its packaging are trademarks of Stark and their use without prior permission is prohibited.

Apple, AirPlay, iPod, iPhone, iPad, iTunes, and the Apple and AirPlay logos are trademarks of Apple Inc. registered in the USA and other countries.

The Spotify and Spotify Connect logos are trademarks of the Spotify Group, registered in the US and other countries.

Spotify software is subject to the following third-party licenses: <https://developer.spotify.com>.

The Bluetooth word mark and logos are registered trademarks owned by Bluetooth SIG, Inc. and any use of them by Stark is governed by license.

Wi-Fi is a registered trademark of the Wi-Fi Alliance.

All other trademarks are the property of their respective owners and use thereof without prior permission is prohibited.

Please note that the availability of third parties and the compatibility of this device with the aforementioned services are subject to the consent of the relevant rights holder, which may be recalled to provide such services, and which may be terminated. Consequently, this device would not be compatible with such third-party services, and Stark bears no related responsibility.

The availability of third party services may require separate agreements between you and the third party. Stark is not responsible for the availability of such services.

Additional legal information regarding this TRUUNE Eighty (80) device and Stark information can be found at <https://www.truune.com>.

## IMPORTANT SAFETY INSTRUCTIONS



This device is designed and manufactured to meet safety standards; however, as with any electrical equipment, care must be taken and safety must be ensured to achieve the best results from the product.

### READ the user manual before using this device

- Keep these instructions for future reference
- Make sure that all electrical connections (including mains plug, extension cords) are correctly made and that they are in accordance with the manufacturer's instructions. Before making or changing electrical connections, switch off the device and remove the mains plug from the mains
- Pay attention to the glass panels on the device
- Make sure there is enough space around the product
- Use only attachments and accessories authorised by the manufacturer
- Place the device on a flat, firm and stable surface
- Have repairs performed by a qualified person
- Do not remove any fixed cover as you may expose yourself to dangerous electrical voltage
- Do not use the product in a humid environment and do not place objects filled with water, such as vases, etc., on the device.
- The ventilation holes on the device must not be covered by other objects; after overheating, the device may be damaged or its service life may be shortened
- Protect the device from direct sunlight, open flames or heat sources such as lit candles or switched on night lamps
- Never place the device on top of other electrical equipment
- Do not use temporary stands and never fasten the legs with wood screws; to ensure overall safety, always install the supplied manufacturer-approved stand or legs with clips according to the instructions
- Above all, DO NOT allow anyone, especially children, to insert anything into the holes, slots, or other openings in the housing - a fatal electric shock could result

# truune<sup>80</sup>

EVOLUTIONARY AUDIO



[truune.com](http://truune.com)